

LYNX®

PARTS
ACCESSORIES
CLOTHING

BEAT EXTREME CONDITIONS

DAN ROGERS:

LIVE TO RIDE

SAFETY ON THE SLOPES
- CONQUER THE PEAKS AND AVOID THE AVALANCHES



CUSTOMIZE YOUR SLED WITH
WRAP KITS



ANKAN DOESN'T SLOW DOWN



BEAT EXTREME CONDITIONS

LYNX[®]

ABS,

THE RESCUE CONCEPT

PAGE 14

FOR FREERIDERS

LYNX FLIGHT

PAGE 9

DRESS CODE:
EXTREME CONDITIONS

LINK
SYSTEM™

GPS

FIND YOUR WAY



LYNX





WHEN LYNX IS A WAY OF LIFE

You already know you can trust your Lynx sled. It has been designed for the challenging, extreme conditions of northern climates, guaranteed to take you all the way to your destination.

Authentic Lynx accessories and riding gear represent the same uncompromising quality. They have been designed to withstand heavy use, year after year. Thanks to Lynx accessories, your sled will always be up to the task, regardless of the terrain and the destination. Specially designed for sled riders, Lynx riding gear keeps you warm and dry whatever the weather, as well as improving your safety.

When you choose Lynx, you can insist on the best: accessories that fit perfectly with your winter lifestyle for even greater enjoyment.

Clothing Technology	7
Deep Snow Sport & Flight Suit.....	8
Safety on the Slopes.....	12
Sport & Denali Suit	16
Customize Your Ride	20
“Ankan” Olsson: High-Speed Summer.....	23
Crossover & Valdez Suit	24
Utility & Fairbanks Suit.....	28
Touring & Kids Suit.....	34
Sportswear.....	38
Hardgear.....	42
All Clothing.....	44
All Models & Platforms 2009 - 2014....	46

ACCESSORIES

Skis	49
LinQ	50
Wind Protection.....	52
Ergonomics	53
Suspension	54
Bumpers & Towing	55
Electric & Rewind Starters	55
Covers & Shovels.....	56
Transmission & Cooling	56
Storage & Seats	57
Electrical	58
Skid Plates & Protectors	59
Oils & Service	60
Tracks & Universal Parts	61
Drive Belts.....	63

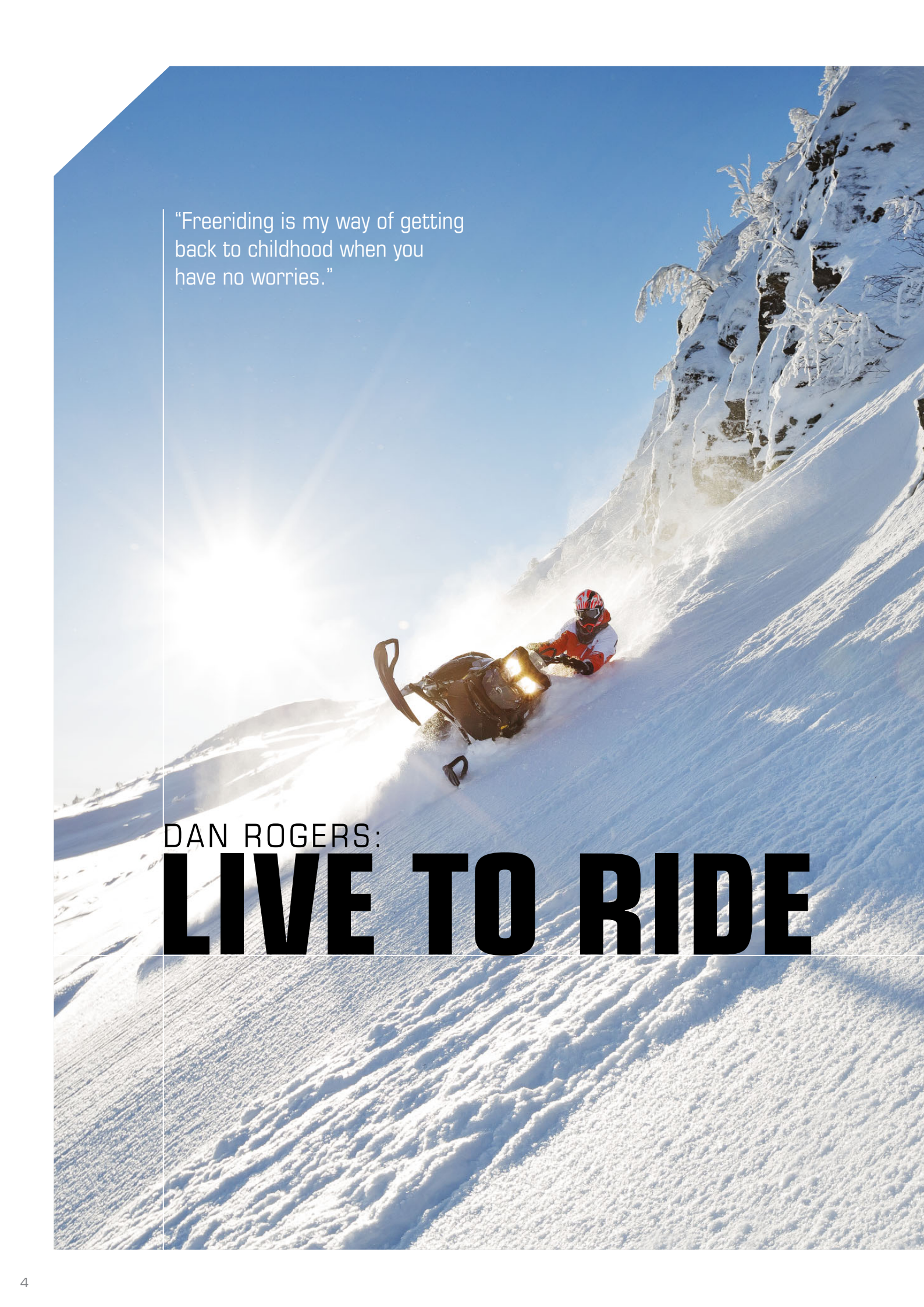
A high-angle, low-perspective photograph of a snowmobiler descending a steep, snow-covered mountain slope. The rider is wearing a red and white jacket and a helmet, and is leaning into the turn. The snow is kicked up behind the sled, creating a misty spray. The sun is low in the sky, creating a strong lens flare and casting long shadows. The background shows more snow-covered trees and a clear blue sky.

“Freeriding is my way of getting
back to childhood when you
have no worries.”

DAN ROGERS:

LIVE TO RIDE



I'VE BEEN A FREERIDER FOR ALMOST ALL MY LIFE.

It feels like I was born addicted to this! I can't think of a time I wasn't looking forward to getting back on the sled. As a kid I took my dad's old sleds out for a spin whenever I had the chance, trying to jump them as far as possible. At 17 I bought my first own sled, an old 1998 Lynx Racing 454 G-Type.

Mainly freeriding is just about having a good time out there, but I also have work assignments in snowmobiling, like shooting films and pics. The camera helps me push the limits. The feeling when I accomplish something I've never done before is what I often seek in freeriding.

I get to ride around 70 days per year. I would do almost anything to be able to ride maybe 40 days more. But our winters just aren't long enough. I do travel a lot to find rideable and good snow. I've also been to Colorado three times this winter. I also bring people over to the USA to show them good times up in the Rockies.

WHAT I LOVE ABOUT FREERIDING

is the feeling of being free and at one with nature. The places I'm able to see in one day would take maybe two weeks to explore on foot. I can always find new jumps, new challenges – and new ways to get myself and my buddies stuck. I can explore nature my way and find all kinds of strange, fun and challenging situations that no one else would even think of. Freeriding is my way of getting back to childhood, when you have no worries, and just relax. Of course you still have to stay focused at all times. If you don't, even the smallest things can get dangerous, and you can get into dumb accidents.

MY IDEAL TERRAIN is steep hills with tight trees and some open spots with big natural jumps all over. That's when the snow is deep, dry and soft. With more springy packed snow I like it up on the mountains with as much jump as possible. My favorite spot in the world so far is Winter Park in Colorado. It's amazing! Whistler in BC, Canada also looks like a place I'd enjoy.

FREERIDING REQUIRES a sled you can ride standing up. You have to be able to feel as one with the sled and make it part of your body. Otherwise you struggle more than necessary and get worn out too fast. And of course the sled has to be reliable. Walking back home three hours all by yourself for three hours in waist-deep snow because



NAME:	Dan Roger Grundstrøm aka "Dan Rogers"
AGE:	30
HOME:	Sørli, Norway
OCCUPATION:	Freerider. Also owns a Ski-Doo, Lynx and Can-Am dealership.

your sled stopped working is something you don't need to experience more than once in a lifetime!

"A lot of people think snowmobilers are lazy, until they try it themselves."

My favorite sled at the moment is definitely the Boon-Docker DS 3900 800R E-TEC. It has a ripping motor, the PPS suspension, and a chassis that just loves all

the beating I'm giving it. With that track length and the narrow front end kit the sled is really stable and easy to sidehill.

I don't usually keep any spare clothing with me, so I need a good quality riding suit to keep me dry and warm for a long day. Clothing has to be comfy, breathable and moveable and prevent snow from getting inside. The new Lynx Flight suit ticks all the boxes. And I haven't even ripped it open from going through all the trees and branches yet, which is impressive. The new Lynx helmet is good for an affordable helmet. I've had more expensive helmets that broke after much less than my Lynx helmet has already endured.

I always have with me the main tools to get out of snow if I have to, and a saw and shovel. When riding with other people you should always bring

avalanche beacons and probes in case of emergency. And of course you need a backpack or some other storage for food and water. I also bring an extra pair of goggles and gloves.

When riding in a bigger group, we all pick our own lines, which means it's hard to keep track of everybody. That's where GPS with tracking comes in handy. GPS is also a necessity when riding in new areas, to make sure I won't get stuck above some cliff, for example. GPS is much cheaper than having to call helicopter evac to get you out.

I RECOMMEND FREERIDING FOR EVERYBODY.

Just get a sled, buy a helmet, kneepads, chest protection, and go out there. Start out on the flat and make sure you understand what the sled is actually able to do.

Watch films and listen to the more experienced freeriders. We're snowmobilers, we all love helping each other out, and we want as many as possible out there to understand this feeling.

Freeriding is also a really good and fun way to exercise. A lot of people think snowmobilers are lazy, until they try it themselves. We're not lazy, we're just awesome!! ■

"I can always find new jumps, new challenges – and new ways to get myself and my buddies stuck."



SEE DAN RIDE: <http://youtu.be/oXMbQKtWoYw>





PRIMALOFT THE INSULATION TECHNOLOGY LEADER.

PRIMALOFT BASE

- Next to down insulation
- Breathable
- Fast drying
- Water-resistant
- Lightweight and compressible
- Thermally efficient

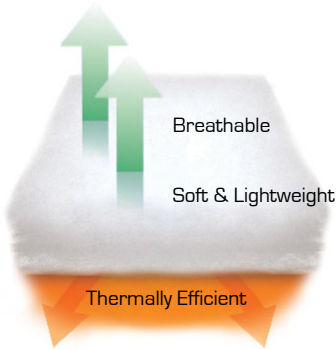

WARMER

Proprietary blend of small diameter fibers trap more air to insulate

DRIER

Special finishes and small diameter fibers make PrimaLoft® insulation water resistant

SOFTER

Finer diameter fibers and proprietary finish make PrimaLoft® insulation ultra soft

MORE COMPRESSIBLE

Smaller diameter fibers allow PrimaLoft® insulation to compress into a smaller space.

DEVELOPED FOR SNOWMOBILERS



DELIVERS THE PERFECT BALANCE OF **WATERPROOFNESS, WINDPROOFNESS AND BREATHABILITY** LIKE NO OTHER PRODUCT IN ITS CATEGORY

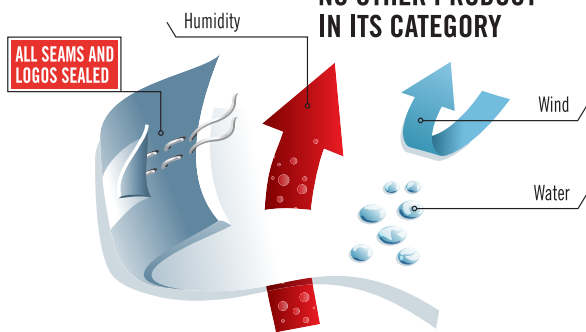

TEFLON TREATMENT IN ALL SHELL FABRICS.

Repels water and stains.



Little Parts. Big Difference.

In riding gear we use YKK high quality AquaGuard® zippers which are developed to meet the challenges of water.

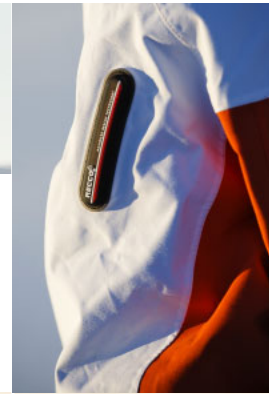

DEEP SNOW SPORT

HEROES OF DEEP SNOW.



WHEN IT'S WINDY UP TOP, the lightly insulated, technical Lynx Flight riding suit keeps you comfortable. The waterproof and windproof suit is specially designed for riding in deep snow, and its Recco system increases snow safety. Thanks to its removable lining, the jacket makes a casual yet stylish outfit for any situation.

JACKET:	PANTS:
XS - 3XL	XS - 3XL
SHELL FABRIC:	
New! RPM Max. Teflon treatment. Nylon.	
FIT:	
Loose-fitted.	
LINING/INSULATION:	
New! Primaloft Base 133 Grams, removable.	New! Primaloft Base 100 Grams.

LYNX FLIGHT

RIDING SUIT

LYNX XR-1

HELMET



JACKET: 650086_12

PANTS: 651086_90

- Removable lining jacket
- Removable hood
- YKK waterproof zippers
- Two-way front zipper
- Double storm flap
- Back ventilation
- Armpit ventilation
- Lycra wrist
- Elastic cord and toggle at hem
- Storm gaiter inside
- 2 side pockets with flaps, velcro and zippers
- Chest pocket with zipper (in the pocket a microfiber cloth to wipe goggles, with elastic cord and clip)
- Ski pass pocket with zipper on left sleeve
- 1 inner chest pocket water- and vapor-proof for cell phone
- D-ring killer loop

- High waist, bib construction, flexible sections on the sides
- Waist adjustment
- YKK waterproof zippers
- Suspenders with adjustments
- Double storm flap with velcro
- Two-way front zipper
- Full-length side zippers
- Leg gaiters with hook to attach boots
- 2 side pockets with waterproof zippers
- 2 cargo pockets at front with waterproof zippers
- Back pockets with flap and zippers
- Belt loops
- Integrated knee pads
- Reinforcement fabric on the leg bottom



DEEP SNOW SPORT. RECOMMENDED ACCESSORIES: BOONDOCKER DS 3900 800R E-TEC.



Enjoyment comes from bottomless powder snow and steep climbs.



WRAP KIT
Powder Advisory

SCS Unlimited's Lynx Exclusive wrap kit guarantees that your BoonDocker sled stands out. For more information about wrap kits, visit scslynxwraps.com.



Heroes are those who are the first to mark the top with their tracks – you and BoonDocker.

THE NEW AND IMPROVED LYNX BOONDOCKER®

range sets the course toward deeper snow and steeper slopes. Like your sled, our accessories are also designed to overcome even the toughest challenges that you and the arctic winter can throw at them. Lynx accessories bring out the best in your sled when you command it in deep snow.

LYNX BACKPACK

860200921

Your freeriding gear and a change of clothes fit handily into a backpack that you can carry the traditional way on your back or strap to the LinQ system. The LinQ attachment kit is sold separately (product No 860200583).



LED BOOSTER LIGHT 
860201050

The first fully-integrated booster light on the sled market produces a powerful, almost 180° beam of light in front of the sled and to the sides. The light attaches handily underneath the standard headlamp and it has ON, OFF and ON HI settings. You no longer have to sacrifice your low beam when you switch to high.



BLADE SKI, GREEN 860201016

Personalize your sled with green Blade skis. Designed for aggressive freeriding, the ski offers not just excellent steering but also a more comfortable riding experience and even better load capacity.



GPS KIT 860200631



Stay on the map! The Garmin Montana 650T GPS kit is one of the best on the market and designed to fit your sled perfectly. Supplied with a plug-and-play wire harness. You will also need a glove compartment extension (860200707). Topographic maps are sold separately.



AVALANCHE ROD 520000408

Lightweight and strong 12-mm aluminum rod for locating avalanche victims. The folding rod has markers every 400 mm. Weight: 370 g.

HANDLEBAR AIR DEFLECTORS 619400081

Protect your hands against arctic winter storms! These hard-wearing air deflectors stay in place and won't interfere with your riding experience. Easy to attach and detach, in seconds.



LinQ BAG, SMALL 860200918, 10 + 3 L

The LinQ system lets you customize the storage space in your sled and attach your bags securely. The stylish black bag is supplied with the LinQ attachment system (860200583).



ABS AVALANCHE AIRBAG SYSTEM BASE UNIT 447590_90

This accessory is your best life insurance in avalanche areas: 97% of avalanche victims who activated their ABS Airbag survived and 84% were totally unharmed. The airbag takes just one tug to activate. The bag has designated spaces for a shovel and an avalanche rod as well as safe compartments for your valuables.

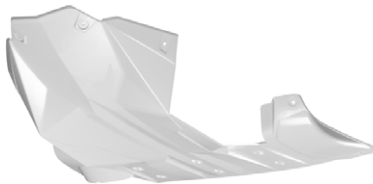

SKID PLATE 860201047

A must-have accessory for challenging terrain – provides extra protection for your BoonDocker's front frame and suspension.



POWDER PLOW SNOW DEFLECTOR 860200603 + 860200937



Specially designed for powder snow, the plow deflects snow to the sides and away from the rider's face. You get better visibility and stay drier. The plow is easy to install underneath the windshield support.



FRONT FOX® FLOAT III SHOCKS 860200958

Lose up to 6 pounds (2.7 kg) over coil spring shocks. Calibrated for optimum performance on summits. Negative spring. Infinitely adjustable main air chamber pressure. IFP (Internal Floating Piston). Advanced high-flow velocity-sensitive damping. Fully rebuildable and revalveable. Comes with a Fox air pump for pressure adjustment. (REV-XM, REV-XP) 36" front suspension 860200958.

FOX FLOAT SHOCK GUARDS 860201011

Lose several pounds and gain easy preload adjustment with Fox air pump. Designed for use with the 900-mm ski stance.

HANDLEBAR BAG, LARGE 860200919

Now you can pack everything you need in rough terrain! The 3-W heater (sold separately, 515176786, requires Heated Visor Kit 860200628 sold separately.) in the bag which attaches to the handlebar keeps your cell phone and GPS warm and functional however cold it is out there. The bag also contains an RCA adapter as well as insulated pockets for two 0.5-L bottles. Installation requires a heated visor kit (860200242, sold separately).

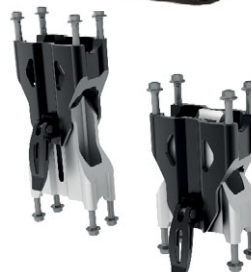

ADJUSTABLE RISER 860201123 Small 860201124 Fatbar 860201125 Fatbar

Maximize your riding comfort by adjusting your riding position to whatever terrain you are in. With a riser you can adjust the height of your handlebar quickly and easily, without tools.

GLOVE COMPARTMENT EXTENSION 860200707

Thanks to the handy extension, you get 50% more storage space in your BoonDocker sled. The glove compartment extension replaces the lid of the standard compartment, and its front panel makes an excellent docking station for your GPS.



LinQ JERRY CAN 860200733

Thanks to the handy LinQ attachment system, the jerry can can be detached and reattached to the sled in seconds.





SAFETY ON THE SLOPES

CONQUER THE PEAKS AND AVOID THE



Mountain guide Jussi Muittari teaches riders to spot avalanches and to take correct action in the face of danger.

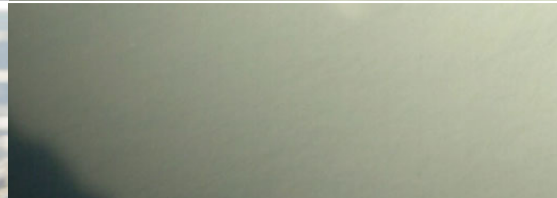

AVALANCHES ARE OFTEN ASSOCIATED with the rugged alpine landscapes of Central Europe. However, avalanches are also a genuine risk factor for riders in Scandinavia.

“An avalanche is generally a possibility on any slope with a gradient of more than 25 degrees as soon as the winter snow cover has formed,” says mountain guide and snow safety trainer **Jussi Muittari**. “A winter snow cover means that snow has covered any natural anchors, such as rocks. If a winter snow cover hasn’t formed, the terrain is generally not good for riding either. The greatest challenge for anyone in these kinds of terrain is to recognize the spots where the slope gradient is more than 25 degrees.”

From the perspective of riders, the most dangerous form of avalanche is the slab avalanche.

“A slab avalanche often starts when the rider is towards the bottom of the slab or in the middle of it. Getting away from the avalanche is extremely difficult, because the snow can reach a speed as high as 60 mph in just a few seconds. Riders who engage in highmarking are especially at risk.”



For more information on courses, visit MOUNTAINGUIDE.FI

AVALANCHES

IT IS POSSIBLE TO PREPARE FOR AN AVALANCHE. Muittari recommends that riders prepare for avalanches even before they set off.

“Choosing the right route is the first and most important step. The next step is to evaluate the risk of avalanches, and there are a few rules of thumb for that. Assessing the weather conditions is also an important part of snow safety.”

Having the right gear can save your life if an avalanche does happen.

“For riders, the most important of these are an ABS backpack, an avalanche transceiver or beacon, as well as a shovel and an avalanche probe. Having the gear alone is obviously not enough; you also need to know how to use it. An average person can survive 15 minutes buried in snow unharmed. An avalanche victim can’t move in the snow and is therefore completely dependent on his rescuers.”

AN AVALANCHE IS LIKE A RAPID IN A RIVER. No matter how well prepared you are, it is not always possible to escape an avalanche. Riders can cover a huge amount of ground in a day, and the snow conditions they come across can vary considerably. Muittari has a checklist of what to do if you see an avalanche heading your way:

“The first rule is to avoid the avalanche! Try to get to the side of it or to higher ground. An avalanche is like a rapid in a river – it goes around

any high points in the terrain. The time to use your personal rescue gear is when you get caught by the avalanche. Open your ABS backpack and try to get rid of your sled, so that your sled is below you.”

INTEREST IN SNOW SAFETY IS INCREASING. Jussi Muittari has been teaching people how to survive in the mountains since 2004. He has also completed the prestigious international mountain guide (UIAGM) training. He became interested in the business through his own hobby.

“I’ve been skiing and climbing rocks and mountains in Scandinavia and in the Alps for almost 20 years. The idea of becoming a mountain guide was always there in the background. Whenever I went with buddies, I’d end up being the leader. I originally trained as a gym teacher, so training people and working with groups came naturally to me.”

In his job as a mountain guide Muittari runs courses for professional and amateur freeriders and other snow sports enthusiasts. His snow safety courses have proven the most

popular, and he also runs courses tailored to sled riders. According to Muittari, all his courses have the same aim:

“My goal is to teach people how to be safer on the slopes and still have fun!” ■

FREERIDER’S SNOW SAFETY KIT

ABS BACKPACK

AVALANCHE BEACON

SHOVEL

AVALANCHE PROBE

FIRST AID KIT

TELEPHONE, a satellite phone where there is no cell phone reception

MAP AND COMPASS for spotting high-risk avalanche areas

GPS

“Getting away from the avalanche is extremely difficult, because the snow can reach a speed as high as 60 mph in just a few seconds.”

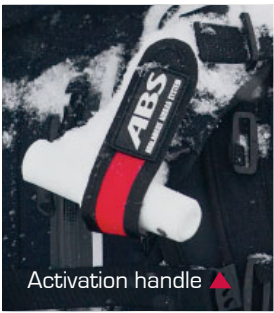

Activation handle ▲

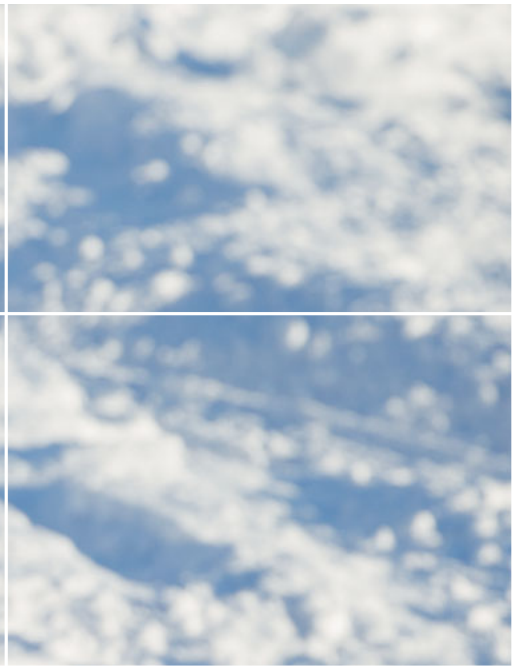

97% OUT OF 262 AVALANCHE VICTIMS WHO ACTIVATED THE ABS AIRBAG SURVIVED PRACTICALLY UNHARMED.

ABS, THE RESCUE CONCEPT:

with one pull on the backpack's activation handle, the tow airbags will inflate in mere seconds to a total volume of 170 liters. This additional volume will likely prevent the burial of the carrier. Two airbags, located on both sides, provide enhanced safety and superior buoyancy effect as well as unobstructed view and full freedom of movement. Please note that the cartridge as well as the activation handle can be re-filled by ABS. The bag itself can be used many times.



◀ The ABS backpack is your best life insurance in avalanche areas

For more information, see page 11.



ZIP-ON pack specially designed for snowmobiling applications that require perfect freedom of movement.

- **MADE OF STRONG** and tough nylon material.
- **EASY-TO-OPEN** main compartment with XL 3/4 zip.
- **QUICK ACCESS** outside holders for shovel blade and shovel shaft.
- **INSIDE** probe holder.
- **MULTIPLE STORAGE** compartments for safe storage of wallet, keys and mobile phone.
- **EMERGENCY** assistance sheet with international emergency numbers on the inside.
- **REFLECTIVE** material at back.

AVALANCHE BEACON 520000408

A lightweight and strong 12-mm aluminum rod designed for locating avalanche victims. The folding rod has markers every 400 mm. Weight 370 g.



GPS KIT 860200631

Track your best routes! The Garmin Montana 650T GPS kit is one of the best on the market and designed to fit your sled perfectly. Supplied with a plug-and-play wire harness. You will also need a glove compartment extension (860200707) for REX² models. Topographic maps are sold separately.

SHOVEL 860200574

Be prepared for avalanches! The generously sized metallic blade of the folding shovel makes digging easier.



RECCO[®]
AVALANCHE RESCUE SYSTEM

More than 100 organizations, including search and rescue teams, utilize **RECCO**[®] technology.

WHEN USED WITH avalanche awareness training, a transceiver and other backcountry safety essentials, the Recco system adds another layer of protection. It can pinpoint the exact location of a burial with harmonic radar and is an additional tool that does not interfere with other rescue methods such as avalanche dogs, transceiver searches or probe lines. Since the reflector is integrated into the jacket and/or highpants, it requires no action on the part of the snowmobiler to function properly. Recco-equipped gear can be washed without damage and will not interfere with any electronic device since it does not transmit any sort of signal. It is not intended for self-rescue and is not an alternative to transceiver use in the backcountry.

LYNX XR-1 HELMET

Aramid fiber cross helmet for protecting your head even in challenging situations. ECE 2205 approved. Removable and washable cheek and head pads, double D racing buckle. Weight 1,250 g.

6640034__00 • XS - 2XL

SPORT

MASTERS OF ARCTIC TRAILS.



THE LYNX DENALI RACE EDITION riding suit is designed for masters of trails and racing tracks who want to ride and live to the max. New surface material and insulation for the 2014 season. The dynamic and trendy look fits perfectly with the design of your Lynx Rave sled.

JACKET	PANTS
XS - 3XL	XS - 3XL
FIT:	
Race. Protective gear taken account in design.	
SHELL FABRIC:	
New! RPM Max. Teflon treatment. Nylon.	
LINING/INSULATION:	
Mesh lining, no insulation.	New! Primaloft Base 60 Grams.

LYNX DENALI RACE EDITION

LYNX XR-1

RIDING SUIT

HELMET



JACKET: 650085_12

PANTS: 651085_90

- Double storm flap
- Adjustment in front collar
- YKK waterproof zippers
- Back ventilation
- Armpit ventilation
- Extra loose construction in back shoulder area gives best fit when using body armors
- Lycra wrist
- 2 side pockets, with fleece lining
- 1 chest pocket

- 1 chest pocket under storm flap, in the pocket a microfiber cloth to wipe goggles, with elastic cord and clip
- 2 inner chest pockets, of which the right side pocket is water- and vapor-proof for the cell phone etc.
- D-ring killer loop
- Orange safety color
- Snow lock on belt

- Preshaped knees
- YKK waterproof zippers
- Waist adjustment
- Suspenders
- Double storm flap
- Reinforcement patches on the leg inside (leather)
- Leg gaiters with hook to attach boots

- Leg openings with zipper
- 2 side pockets
- D-ring killer loop
- Side ventilation
- Reinforcement fabrics on the leg bottom
- Orange safety color



SPORT. RECOMMENDED ACCESSORIES: RAVE RE 800R E-TEC.



LYNX RAVE SLEDS offer ultimate rideability, sportiness and comfort. Bring out the best features of your sled with authentic accessories.

Tame even the bumpiest routes with the master of arctic trails!



LinQ BAG, SHORT
860200918, 10 + 3 L

The LinQ system lets you customize the storage space in your sled and attach your bags securely. The stylish black bag is supplied with the LinQ attachment system (860200583).

VENTILATION KIT
860200684

These custom-made valves quickly lower the temperature in your engine bay in heavy use. Designed for racing tracks, the kit is easy to install in most chassis panels.



LED BOOSTER LIGHT 
860201050

The first fully-integrated booster light on the sled market produces a powerful, almost 180° beam of light in front of the sled and to the sides. The light attaches handily underneath the standard headlamp and has ON, OFF and ON HI settings. You no longer have to sacrifice your low beam when you switch to high.



BLADE SKI, WHITE
860200885

Designed for aggressive trail riding, the ski offers extremely precise steering and a comfortable riding experience even in high speeds, without pulling or darting.



HANDLEBAR BAG, LARGE
860200919

Now you can pack everything you need in rough terrain! The 3-W heater (sold separately, 515176786, requires Heated Visor Kit 860200628 sold separately.) in the bag which attaches to the handlebar keeps your cell phone and GPS warm and functional however cold it is out there. The bag also contains an RCA adapter as well as insulated pockets for two 0.5L bottles. Installation requires a heated visor kit (860200242, sold separately).



SKID PLATE, BLACK
860201046

Extra protection for the front frame and suspension of your sled on rough trails.



WINDSHIELD, HIGH 
860201070

Protect yourself from the wind with a high windshield that complements the style of your sled.



GPS KIT 
860200631

Track your best routes! The Garmin Montana 650T GPS kit is one of the best on the market and designed to fit your sled perfectly. Supplied with a plug-and-play wire harness. You will also need a glove compartment extension (860200707). Topographic maps are sold separately.



SIDE COVER AIR DEFLECTORS 
860201068

Complete the sporty look of your sled with air deflectors that deflect the wind past your legs.

QRS RACING SUPPORT
860200783

QRS tower support as is used by the factory snowcross teams. Helps to keep the pulley alignment ideal in all conditions.

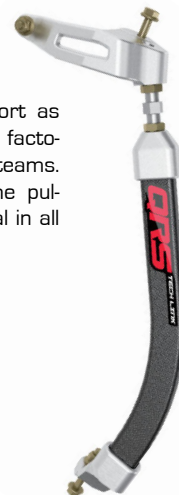

GLOVE COMPARTMENT EXTENSION
860200707

Thanks to the handy extension, you get 50% more storage space in your sled. The glove compartment extension replaces the lid of the standard compartment, and its front panel makes an excellent docking station for your GPS.

YOUR CUSTOMIZE RIDE!



◀ "If you're looking for a race-inspired kit, check out the Transformer."

In the heart of the Rocky Mountains the guys at SCS Unlimited create custom graphics kits for Lynx sleds. Their goal? To make people look good out on the snow!



From left to right: Josh Watkins, Devin Karr and Paul Guest.

SCS UNLIMITED DOES UNIQUE DESIGNS FOR EXTREME CONDITIONS

"WITH THE RELEASE OF LYNX REX² we have created some designs to really accentuate the new body style," says **Joshua Watkins**, one of the lead designers and art directors at SCS Unlimited. "The 2014 SCS Lynx wrap kits have a unique style and are said to be the best-looking wrap kits out on the market today."

Watkins hints that the designs to watch out for are Powder Advisory, Sunday's Best, Altered State, and Doodle Bot.

"If you're looking for a race-inspired kit, check out the Transformer or Floored kits to really ignite the fury. Every kit is fully customizable, from color changes to logo additions."

CUSTOMIZING IS A RISING TREND. As a designer, Joshua Watkins is inspired by everyday experiences, which he then aspires to transcribe into a design or graphic that people will make a connection with. Keeping an eye on trends is also part of the job.

"I think it's important to utilize certain trends; after all it's what people are craving at the moment. It's also important to be able to project a couple of years ahead to predict what is going to be trending. If you are able to pull that off you essentially set the trend. The best part is that trends are always changing which allows us to keep it fresh. I find it most effective when you use a trend as a



Joshua Watkins and Sunday's Best.

base and build off of it to make it your own."

"Trends at the moment are the use of bold colors with bold shapes, the juxtaposition of textures and shapes of color to produce depth and layers. The biggest trend right now is the customization of consumer products. The concept has been around for a while but has really blown up in the last couple of years, and can be expected to increase more in the next couple of years. With an SCS Lynx Sled Wrap the consumer can customize the look of his/her wrap kit with custom color changes and logo additions."

EXPRESS YOURSELF WITH YOUR SLED! Customization is a trend that appeals to riders of all ages.

"I believe that the beauty of the consumers who are buying our wrap kits is the fact that they are ever evolving," says **Devin Karr**, graphic designer and President



2. 3.
4. 5.



Wrap designs: 2. Powder Advisory 3. Sunday's Best 4. Altered State 5. Doodle Bot 6. Floored.

of SCS Unlimited. "I think the younger generation found it was a great way to express themselves, while the older generation riders are realizing they can do that too, just some in more of a classy or subtle method. I think consumers of all ages are finding they enjoy personalizing their machines one way or another."

"An SCS wrap is the easiest way to personalize and protect your sleds. We offer an unlimited variety of ways to make your sled one-of-a-kind, promote your sponsors and businesses, and of course stand out in the crowd," adds **Paul Guest**, who manages design production, as well as installing vinyl and sled wraps at SCS.

Lynx REX² design definitely had us excited. I feel it has a cutting edge look, and was a great blank canvas to work on!"

In addition to looking good, the wraps have to be durable in even the most extreme conditions.

"We choose the best materials for our wraps. BRP does 2,000+ hours of testing before our products are released," says Paul Guest. "Our 0,0889 mm base vinyl has engineering grade adhesive to stick to challenging surfaces and is protected with a high gloss 0,2032 mm laminate specifically made to work with the contours of sleds. Our Eco-Sol Max ink ensures that the colors will never fade." ■

LOOKING GOOD FOR YEARS TO COME.

Before the actual design process of a wrap kit starts, an important step is getting to know the sled model in question.

"Knowing the anatomy of the sled allows you to highlight your design elements with the different shapes and curves of the body. It's amazing how much a design transforms once it's taken from a computer screen to the actual sled," Devin Karr says. "The new



The Lynx buffs use the same graphics as the tape series. For more information, see page 40.

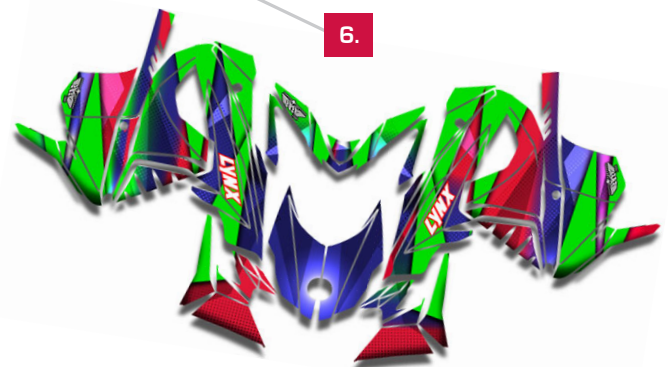

6.

DIY

— HOW TO INSTALL YOUR WRAP KIT PROPERLY

1. The MOST important step is to clean your sled. It's all about the prep-work. The most common mistake is waxy residue left on your plastic, possibly from the showroom floor while a new sled is "shined" up.
2. Take your time. Installed properly, your wrap can last the life of your sled, so it's worth a few extra minutes.
3. Before you start, check out the install video at scsunlimited.com

Expert advice by Paul Guest



For more information: SCSLYNXWRAPS.COM

Anders Olsson, Nicknamed **"Ankan"** since kindergarten. **Age:** 33. **Lives in:** Umeå, Sweden. **Known for:** Freerider in the RuffRiders video series. **Favorite skateboard trick:** Nollie switch crooks. **Also enjoys in summer:** Riding his motard, fishing, barbecues, and just relaxing.

SEE ANKAN RIDE:

<http://youtu.be/oXMbQKtWoYw>



Freerider's HIGH-SPEED SUMMER

"Ankan" Olsson spends winters performing daring freeride stunts for the camera. But even when the snow melts, he doesn't slow down.

"I STARTED TO RIDE my dad's old snowmobile when I was about 16. First it was just trail riding, nothing spectacular. I was maybe 25 when I started jumping and doing tricks. The RuffRiders snowmobile video series was started nine years ago by Petter Grimborg. We're basically a group of friends from all over Sweden, having fun on our sleds.

Even before the sleds there was skateboarding. I started to skate when I was 14, so it's been almost 20 years now. I skate all year round. In my hometown Umeå we have a nice indoor park and a big outdoor concrete park. Our local skate park is my favorite spot to skate at, because it's only 5 minutes from my apartment, and it's concrete.

I don't think freeriding makes me better at skateboarding, or vice versa. They're two completely different sports. On the other hand, the communities are very similar. You have cameramen and photographers, magazines, videos, contests, etc. I do kind of the same thing when I skate as when I ride sleds: meet some friends, film, take photos, go on road trips.

A lot of clothing brands are also the same in both scenes. In

skateboarding there are no rules when it comes to clothing - some people like tight jeans, others like something looser. I prefer wearing something in between: not too tight, not too baggy. I guess you wear what you feel comfortable in, and what you think looks good." ■

"I really like the design of the BoonDocker cap, and the flannel shirt is definitely a new favorite."

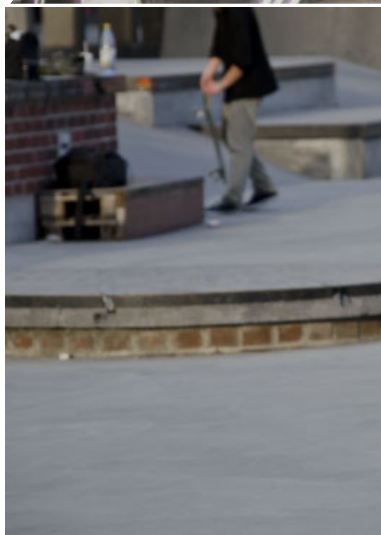

CROSSOVER

CHAMPIONS OF CHALLENGING TERRAIN.



THE NEW STYLE and materials of the Lynx Valdez riding suit offer versatility and ultimate comfort – just like your Lynx Xtrim sled. The sporty jacket and hard-wearing pants keep you dry and warm on long trips and in challenging terrains.

JACKET:	PANTS:
XS - 4XL	XS - 3XL
FIT:	
Sporty	
SHELL FABRIC:	
New! RPM Max. Teflon treatment. Nylon.	
LINING/INSULATION:	
New! Primaloft Base 100 Grams.	

LYNX VALDEZ

RIDING SUIT

LYNX XR-1

HELMET

Removable protectors,
back and sleeves

Two chest pockets with zipper,
in the left chest pocket a microfiber cloth to
wipe goggles, with elastic cord and clip

Storm gaiter

Side ventilation

Preshaped knees

Leg gaiters with hook
to attach boots



JACKET: 650087_07

PANTS: 651087_90

- Double storm flap
- YKK waterproof zippers
- Back ventilation opening
- Armpit ventilation
- Self fabric velcro tab in the cuffs
- Lycra wrist
- Velcro adjustments at hem
- Storm gaiter
- Removable protectors, back and sleeves
- 2 side pockets
- Two chest pockets with zipper, in the left chest pocket a microfiber cloth to wipe goggles, with elastic cord and clip
- 1 time card pocket on left sleeve cuffs
- 1 inner chest pocket water- and vapor-proof for cell phone
- D-ring killer loop

- Extra padding on seat
- YKK waterproof zippers
- Waist adjustment
- Suspenders
- Double storm flap with velcro tabs and 2 snaps
- Two-way front zipper
- Leg gaiters with hook to attach boots
- 2 side pockets with waterproof zipper
- Side ventilation
- Reinforcement fabric on the legs and seat
- Preshaped knees



2 X LinQ BAG
 860200917 Medium 19 + 3 L
 860200918 Small 10 + 3 L

THE SLEDS IN THE LYNX XTRIM range are made to deal with all kinds of conditions to let you make the most of the winter. Thanks to the wide range of accessories, you can customize your sled for your exact needs.



GPS KIT 
 860200631

Chart the most interesting terrains! The Garmin Montana 650T GPS kit is one of the best on the market and designed to fit your sled perfectly. Supplied with a plug-and-play wire harness. You will also need a RAM GPS holder (860200725) or a universal holder with a Garmin attachment plate (860200631).



WINDSHIELD, HIGH 
 860201070

Protect yourself from the wind with a high windshield that complements the style of your sled.



SIDE COVER AIR DEFLECTORS 
860201068

Make your trip more comfortable with air deflectors that deflect the wind past your legs.



GLOVE COMPARTMENT EXTENSION, BLACK
860200707

Thanks to the handy extension, you get 50% more storage space in your sled. The glove compartment extension replaces the lid of the standard compartment, and its front panel makes an excellent docking station for your GPS.



HANDLEBAR BAG, LARGE
860200919

Now you can pack everything you need in rough terrain! The 3-W heater (sold separately, 515176786, requires Heated Visor Kit 860200628 sold separately.) in the bag which attaches to the handlebar keeps your cell phone and GPS warm and functional however cold it is out there. The bag also contains an RCA adapter as well as insulated pockets for two 0.5-L bottles. Installation requires a heated visor kit (860200242, sold separately).



RE SHOCK KIT

860201052
Shock absorber kit for platform, complete



860201051
Shock absorber kit for skis, complete



BOOSTER BUMPER

860200932

A stylish aluminum bumper that gives your Xtrim sled extra protection in challenging terrain.

BLADE SKI, BLUE

860201015



Designed for arctic conditions, the multilayer bottom structure of the Blade ski, 188-mm width and aggressive profile guarantee directional stability and precise steering.



J-HOOK

860200886

Hook on a cargo sled and you're good to go: This hook kit transforms your sled into a beast of burden. Available for models with a reinforced rear bumper.



LED SIGNATURE LIGHTS

860201074



LinQ CARGO BOX, LARGE

860201082

Volume 40 L. Only available for 3,700-mm+ models.



LinQ 1+1 SEAT 

860201058

Ready your Xtrim sled for adventure with LinQ accessories. Fit the 1+1 seat in just 20 seconds and you can take a buddy along.



LED BOOSTER LIGHT 

860201050

The first fully-integrated booster light on the sled market produces a powerful, almost 180° beam of light in front of the sled and to the sides. The light attaches handily underneath the standard headlamp and it has ON, OFF and ON HI settings. You no longer have to sacrifice your low beam when you switch to high.

UTILITY

HEROES OF HARD WORK.



HARD WORK REQUIRES durability – also from clothing. The Lynx Fairbanks suit is designed for heavy wear in extreme conditions. Its new materials protect professionals against sub-zero temperatures even better than before, whether on building sites or when ice fishing.

JACKET:	PANTS:
XS - 3XL	XS - 3XL
FIT:	
Comfort	
SHELL FABRIC:	
New! RPM Max. Teflon treatment. Polyester.	
LINING/INSULATION:	
New ! Primaloft Base 133 Grams.	

LYNX FAIRBANKS

MODULAR

RIDING SUIT

HELMET



Removable hood

Back ventilation/
Armpit ventilation

High waist

Two inner chest pockets,
of which the right side pocket is
water- and vapor-proof for the
cell phone etc.

Side ventilation

Extra padding on seat and knees



JACKET: 650088_90

PANTS: 651088_90

- Removable hood
- Double storm flap
- YKK waterproof zippers
- Back ventilation
- Armpit ventilation
- Lycra wrist
- Elastic cord and toggle adjustment at hem and waist
- 2 side pockets, fleece lining
- 2 chest pockets
- 1 chest pocket under storm flap, in the pocket a microfiber cloth to wipe goggles, with elastic cord and clip
- Two inner chest pockets, of which the right side pocket is water- and vapor-proof for the cell phone etc.
- D-ring killer loop

- Two-way front zipper
- Extra padding on seat and knees
- YKK waterproof zippers
- High waist
- Waist adjustment
- Suspenders
- Double storm flap
- Leg gaiters with hook to attach boots
- 2 side pockets
- 2 cargo pockets
- Side ventilation
- Reinforcement fabric on the legs and seat



UTILITY. RECOMMENDED ACCESSORIES: 69 YETI ARMY 600 E-TEC.



Some jobs need to be done whatever the conditions. With two heroes of hard work – you and Lynx – working together, there is no job too big.

LYNX UTILITY SLEDS are designed for challenging Nordic conditions that put high demands on snowmobiles. Our authentic accessories also meet these same demands.



LinQ CARRIER CARGO SLED
860201065

Turn your sled into an mighty beast of burden with a LinQ cargo carrier. This hi-tech sled has independent suspension, which guarantees a smooth ride for your cargo as well. The sled in the picture is equipped with extra sides, 2 x 715001665.



LinQ CARGO BOX, 360 L

860201066

High-quality cargo box to protect your cargo whatever the weather. The box has steel rails for attaching cargo, and the lid is protected by teak borders.



HEAVY-DUTY SKID PLATE, BLACK



860200691

The hard-wearing polyethylene skid plate offers ultimate protection for your front suspension and prevents snow from sticking to the frame. Only available for the 69 YETI.



LinQ BAG, MEDIUM, 19 + 3 L

860200917

Durable bag for extra storage space for tools and other gear. For maximal storage space, combine with a small LinQ Premium bag in a track tunnel of at least 137". Supplied with the LinQ attachment kit.



GPS KIT

860200631



GPS helps you to locate even the most remote building sites and the best ice fishing spots. The Garmin Montana 650T GPS kit is one of the best on the market and designed to fit your sled perfectly. Supplied with a plug-and-play wire harness. You will also need a RAM GPS holder (860200725) or a universal holder with a Garmin attachment plate (860200631). Topographic maps are sold separately.



LinQ SYSTEM™

LinQ JERRY CAN

860200733

Thanks to the handy LinQ attachment system, the jerry can can be detached and reattached to the sled in seconds.



LinQ RACK

860201003



Just replace your passenger seat with this rack and you can have a LinQ jerry can and a LinQ bag on board in seconds. With LinQ accessories, your YETI sled is always up to the task, whether business or leisure.



HEAVY-DUTY FRONT BUMPER

860200391

Extra protection for your sled in rough terrain.

UTILITY

69 RANGER™ ALPINE™



NEW RANGE OF PROFESSIONAL accessories for the new and improved Lynx 69 Ranger Alpine. All accessories are designed specifically for ski center maintenance.



SKID PLATE

860200549

Black



Brake on



Brake off

HILL BRAKE 
860200716

Advanced hill brake application for safe stopping on steep hills.



REAR RACK BOX 
860200768

Large cargo box for mounting on the rear rack.

**SKI/
SNOWBOARD RACK**
860200756
(No photo)

Rack for two pairs of skis and a snowboard.



SIGNAL LIGHTS
860200755

Signal lights include warning and work lights.



**CTEK BRP
5.0 BATTERY CHARGER** 
860200997

CTEK – manufacturer of the world's most advanced battery chargers – has developed a charger that works with all BRP products. The charger is specially designed for arctic conditions. The charger is supplied as standard with the Lynx 69 Ranger Alpine and is available as an accessory for all battery-powered BRP snowmobiles. For more information, ask your local dealer.

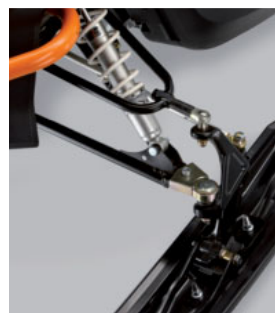

WIDENING KIT
860200835

Widening kit with an A-arm. More stability when turning on steep slopes. Adds 92 mm of width to the front suspension.

TOURING

YOUR PARTNER ON A PERFECT WINTER DAY.



EVEN IF THE SPRING SUN goes and hides behind a cloud, the new and improved Lynx Kids suit keeps the smallest members of your expedition warm – and content. The suit also provides excellent protection during break-time snow games! The rider's choice for a wintry expedition is the warm and hard-wearing Lynx Fairbanks suit.

SUIT:
2, 3, 4, 5, 6
FIT:
Sporty.
SHELL FABRIC:
New! RPM Max. Teflon treatment. Nylon.
LINING/INSULATION:
New! Primaloft Base 133 Grams.

LYNX FAIRBANKS

RIDING SUIT

LYNX KIDS

CHILDREN'S SUIT



Fleece inside the collar

Double storm flap

Reinforcement patches on seat and knees

Adjustable leg length



JACKET: 650088_90	JACKET: 657003_30	PANTS: 657003_30
PANTS: 651088_90	<ul style="list-style-type: none"> • Two-way front zipper • YKK waterproof zippers • Fleece inside the collar • Removable hood • Double storm flap • Elastic cord and adjustment toggle at hem 	<ul style="list-style-type: none"> • High waist with zipper • YKK waterproof zippers • Suspenders • Leg gaiters • Adjustable leg length • Reinforcement patches on seat and knees
See page 29 for details on the Fairbanks suit.	<ul style="list-style-type: none"> • Fleece wrists • 2 side pockets with zippers, with fleece lining • D-ring killer loop 	

TOURING. RECOMMENDED ACCESSORIES: ADVENTURE GRAND TOURER 1200 4-TEC.



On a Lynx touring sled you will enjoy every moment of a winter day.

THE LYNX ADVENTURE range offers the most comfortable ride in wintertime nature. The correct accessories give both rider and passenger the ultimate riding experience.



SKID PLATE, BLACK

860200549

Hard-wearing polyethylene skid plate for ultimate front suspension protection. Also for use with A-arm protectors.



A-ARM PROTECTORS

619590071

Ensure the smoothness of your trip with protectors that prevent snow from sticking to your sled's A-arm and improve rideability in deep snow.



BLADE SKI LINER, SYMMETRICAL

860200749

There's no need to worry even if the trail is covered in deep snow: The Blade ski liner improves the load capacity of your sled.



HEAVY-DUTY FRONT BUMPER

860200537

Extra protection for your sled.

HANDLEBAR BAG, LARGE

860200919



LinQ BAG, MEDIUM, 19 + 3 L

860200917



Durable bag for extra storage space for tools and other gear. For maximal storage space, combine with a small LinQ Premium bag in a track tunnel of at least 137". Supplied with the LinQ attachment kit.



The bag attaches to the handlebar and takes everything your family might need on your trip. The 3-W heater (sold separately, 515176786) keeps your cell phone and GPS warm and functional however cold it is out there. The bag also contains an RCA adapter as well as insulated pockets for two 0.5-L bottles. Installation requires a heated visor kit (860200242, sold separately).



GPS KIT

860200631



Stay on track! The Garmin Montana 650T GPS kit is one of the best on the market and designed to fit your sled perfectly. Supplied with a plug-and-play wire harness. You will also need a RAM GPS holder (860200725) or a universal holder with a Garmin attachment plate (860200631). Topographic maps are sold separately.



LinQ CARGO RACK

860201003



LinQ accessories ready your sled for whatever kind of trip you have in mind. Just replace your passenger seat with this rack and you can have a LinQ jerry can and a LinQ bag on board in seconds.





SPORTSWEAR

BE CASUAL WITH STYLE.



LYNX FLANNEL SHIRT

660023_30

NEW Shirt for freetime use "after riding". Trendy cut with Lynx embroideries. Quality flannel fabric that is comfortable to wear. Button closure. Modern cut and outlook. Chest pockets with buttons. Shirt cuffs. Reinforcement patches on elbows. 100% Cotton Check Flannel.

Red. Fitted cut
XS - 3XL



DRESS CODE: CASUAL. Lynx is your label even when you've parked your sled - for the evening or until the beginning of the next riding season. Whether you spend your free time relaxing or engaging in other extreme sports, high-quality Lynx sportswear is comfortable and hard-wearing. Nail your colors to the mast with style!



LYNX BEANIE

6652390090

Soft high-quality beanie with Lynx text. 100% acrylic with double binding.

Black/White.



BOONDOCKER BEANIE

6652400090

Soft high-quality beanie with BoonDocker graphics. 100% acrylic with double binding.



BOONDOCKER CAP

665037_12

Trendy straight cap with BoonDocker graphics. Bold cotton twill material. 98% cotton, 2% spandex.

Black/Orange
S/M, L/XL



LYNX FLEECE

659038_90 Black/Gray
659043_12 Black/Orange

LYNX JUNIOR FLEECE

661008_90 Black/Gray
661010_12 Black/Orange

Soft and warm fleece for midlayer and free-time use. Material polyester polar fleece, brushed flatlock stitches to add comfort and a modern look, Lynx racing details and sponsor logos. Designed for use as a midlayer fleece. Preshaped sleeves, YKK zippers, chest and side pockets with zippers, elastic draw cord at hem. Also kids' sizes in both colors. 100% polyester.

Black/Gray, Black/Orange
Fitted/Regular cut
XS - 3XL

Children's sizes: 2, 4, 6, 8, 10, 12



LYNX RACING CAP

6650350090

Racing-inspired high-quality cap with an adjustable strap. Comfortable material with stretch. 97% polyester, 3% spandex. One size.

Black/Gray



LYNX CLASSIC CAP

665036_90

Stylish and high-quality Lynx cap. Comfortable technical material with stretch.

Black.
S/M, L/XL





LYNX T-SHIRT

662053_90

High-quality T-shirt with graphic print and Lynx details. 100% cotton. Black. Fitted cut.

XS - 3XL



LYNX LADIES T-SHIRT

662054_90

High-quality Ladies T-shirt with graphic print and Lynx details. Feminine cut and comfortable cotton stretch material. 95% cotton, 5% spandex. Black.

XS - 2XL



LYNX BUFF

6652450018
6652440018

Multiple uses: Wear as a neckerchief, scarf, hair tie, wristband, bandana or balaclava. High-quality 100% polyester microfiber. No seams. Elastic fabric that keeps its shape. Graphic design in collaboration with SCS.

LYNX HOODIE

659040_90

High-quality hoodie with graphic print. Full-length zipper, side pockets and Lynx details.

XS - 3XL



LYNX RIDING GLOVES

666026_90

Hipora membrane for more breathability. Stay-dry moisture management lining. Stretch texturized fabric facilitates movement. Padded knuckles. Rubber palm and finger print for improved grip. Adjustable wrists.

HARDGEAR



LYNX XR-1 SUN VISOR
6690140000
Supplied with screws.



MORPHO KIT FOR LYNX XR-1 HELMET
447436_00
Clear

For a perfect custom fit. Left and right side included.
L-2XL

LYNX XR-1 HELMET 
6640034_00

Aramid fiber cross helmet for Lynx riders. ECE 2205 approved. Removable and washable cheek and head pads, double D racing buckle. Weight 1,250 g. XS - 2XL



LYNX WARM-UP JACKET
6520170090

Loosely fitting jacket for warming up and for wearing in the pits. Racing-inspired Lynx details and sponsor logos. Nylon surface with Thermal Loft insulation. O/S

- Critical seams taped.
- YKK zippers.
- Fleece collar.
- Large, adjustable hood.
- Generous hand warmer pockets.



XP-R2 CARBON LIGHT HELMET

447656_90F

Top-quality lightweight carbon fiber helmet. Carbon-fiber/aramid-reinforced shell. Adjustable sun visor with non-reflecting coating on the inside. Flexible and protective nose guard. Double D racing buckle. Removable and washable cheek and head pads, 10 air holes. ECE approved. Shell: Carbon fiber. XS - XL



MODULAR 2 HELMET

445935_90F • 339 EUR



Modular helmet with double visor and integrated sunshield. Fog-resistant breathing airflow control. Micrometric quick-release mechanism for added ease of use. S - 3XL



SUN VISOR, FOR MODULAR 2 HELMET

4459710057

One size.



ELECTRIC VISOR, FOR MODULAR 2 HELMET

4475160000



MASK FILTER, FOR MODULAR 2 HELMET

4456290001F

Pack of 10.



REPLACEMENT VISOR, FOR MODULAR 2 HELMET

4459670000

Sun visor not included.

ABS AVALANCHE AIRBAG



ABS VARIO SUMMIT SB BACKPACK

5 L • 4476900030 • Red

15 L • 4476430080 • Blue

100% nylon.

One size.



With airbags inflated.

ABS AVALANCHE AIRBAG

447590_90

SYSTEM Base Unit

100% nylon.

S/M, M/L

Black

ABS AIRBAG ACTIVATION UNIT

4475930000

Steel cartridge.

One size.

Clear.

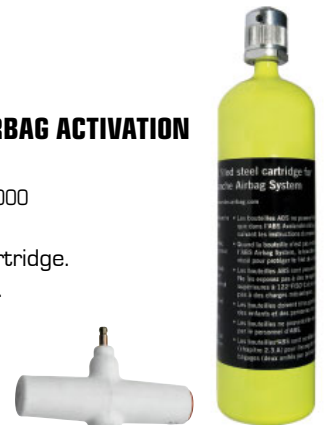



LYNX FLIGHT

Jacket: 650086_12
p. 9



LYNX DENALI

Jacket: 650085_12
p. 17



LYNX VALDEZ

Jacket: 650087_07
p. 25



LYNX FAIRBANKS

Jacket: 650088_90
p. 29



LYNX FLIGHT

Pants: 651086_90
p. 9



LYNX DENALI

Pants: 651085_90
p. 17



LYNX VALDEZ

Pants: 651087_90
p. 25



LYNX FAIRBANKS

Pants: 651088_90
p. 29

WHAT CODE SIZE?
REPRESENTS YOUR

1. Find your size.
2. The corresponding code is THE CODE you use to complete the part number on your order.

Example: 659 040 ____ 90
Size: M = code "06"

▶ 659 040 **06** 90



LYNX KIDS

Riding Suit: 657003_30
p. 35



SIZE	CODE	SIZE	CODE
ONE SIZE	00	2	21
XS	02	3	22
S	04	4	23
M	06	5	24
L	09	6	25
XL	12	8	28
2XL	14	10	30
3XL	16	12	32
4XL	18	S/M	72
		M/L	91
		L/XL	73

SPORTSWEAR



LYNX BEANIE
6652390090
p. 38



BOONDOCKER BEANIE
6652400090
p. 38



BOONDOCKER CAP
665037_12
p. 38



LYNX RACING CAP
6650350090
p. 39



LYNX CLASSIC CAP
665036_90
p. 39



LYNX FLANNEL SHIRT
660023_90
p. 38



LYNX FLEECE
659038_90 black
659043_12 orange



LYNX HOODIE
659040_90
p. 41



LYNX T-SHIRT
662053_90
p. 40



LYNX LADIES T-SHIRT
662054_90
p. 40

LYNX JUNIOR FLEECE

661008_90 black
661010_12 orange
p. 39

HARDGEAR



XP-R2 CARBON LIGHT HELMET
447656_90F
p. 43



LYNX XR-1 HELMET
6640034_00
p. 42



MODULAR 2 HELMET
445935_90F
p. 43



LYNX RIDING GLOVES
666026_90
p. 43



LYNX BUFF
6652450018
6652440018
p. 40

ABS AVALANCHE AIRBAG



5 L

ABS VARIO SUMMIT SB BACKPACK
4476900030 red
4476430080 blue
p. 43



15 L



ABS AVALANCHE AIRBAG
447590_90
p. 43



ABS AVALANCHE AIRBAG ACTIVATION UNIT
4475930000
p. 43



SEWARD WARM-UP JACKET
6520170090
p. 42

2014

XU Adventure Grand Tourer 600 E-TEC
Adventure Grand Tourer 1200 4-TEC
Adventure Grand Tourer 1200 CE

REX Adventure LX 600 ACE
49 Ranger 600 E-TEC
49 Ranger 600 ACE

59 YETI 600 ACE

XU 59 YETI 550
69 YETI 600 ACE
69 YETI ARMY 600 E-TEC
69 Ranger Alpine 1200 4-TEC

REX Rave RE 800R E-TEC
Rave RE 600 E-TEC

REX Rave 600 ACE
Rave 550
Xtrim 600 ACE

Xtrim SC 600 E-TEC

REX Xtrim SC 900 ACE
BoonDocker RE 3700 800R E-TEC
BoonDocker 3700 600 E-TEC
BoonDocker DS 3900 800R E-TEC
BoonDocker 3900 600 E-TEC

XU Xtrim Commander 600 E-TEC
Xtrim Commander 600 E-TEC LTD
Xtrim Commander 800R E-TEC



BOONDOCKER
• DS 3900 800R E-TEC
• RE 3700 800R E-TEC
• 3900 600 E-TEC
• 3700 600 E-TEC

2013

XU Adventure Grand Tourer 600 E-TEC
Adventure Grand Tourer 1200 4-TEC
Adventure Grand Tourer 1200 CE

REX Adventure LX 600 ACE
49 Ranger 600 E-TEC
49 Ranger 600 ACE

59 YETI 600 ACE

XU 59 YETI 550
69 YETI 600 ACE
69 YETI Army 600 E-TEC
69 Ranger Alpine 1200 4-TEC

Rave RE 800R E-TEC
Rave RE 600 E-TEC

REX Rave GLS 3300 800R E-TEC
Rave 600 ACE
Rave 550
Xtrim 550
Xtrim 600 ACE
Xtrim SC 600 E-TEC

BoonDocker 3700 800R E-TEC
BoonDocker 3700 600 E-TEC
BoonDocker 3900 800R E-TEC

XU Xtrim Commander 600 E-TEC
Xtrim Commander 600 E-TEC LTD



RAVE
• 550
• 600 ACE



XTRIM 600 ACE

2012

XU Adventure Grand Tourer 600 E-TEC
Adventure Grand Tourer 1200 4-TEC

REX Adventure LX 600 ACE
49 Ranger 600 E-TEC
49 Ranger 600 ACE

YETI Pro 800 Army (YETI)*

XU 59 YETI 600 ACE
59 YETI 550
69 YETI 600 ACE

Rave RE 800R E-TEC
Rave RE 600 E-TEC

REX Rave SC 600 E-TEC
Rave 600 ACE
Rave 550
Xtrim 550
Xtrim 600 ACE
Xtrim SC 600 E-TEC
Xtrim SC 800R E-TEC
Xtrim BoonDocker 800R E-TEC

XU Xtrim Commander 600 E-TEC
Xtrim Commander 600 E-TEC LTD



RAVE
• RE 800R E-TEC
• RE 600 E-TEC



XTRIM SC
• 900 ACE
• 600 E-TEC

* For more information about accessories for RF, REVO and YETI sleds, ask your local dealer!

2011

XU Adventure Grand Tourer 600 E-TEC
Adventure Grand Tourer 1200 4-TEC

REX Adventure 600 ACE
49 Ranger 600 E-TEC

XU YETI Pro 800 (YETI)*
YETI 550 (YETI)*

XU 59 YETI 600 ACE

REX Rave RE 800R E-TEC
Rave RE 600 E-TEC
Rave SC 600 E-TEC
Rave 550
Xtrim FC 550
Xtrim SC 600 E-TEC
Xtrim BoonDocker 800R E-TEC

XU Xtrim Commander 600 E-TEC

2010

XU Adventure Grand Tourer 600 E-TEC
Adventure Grand Tourer 1200 4-TEC

YETI Pro 800 (YETI)*
YETI Pro 550 2009 (YETI)*

REX Rave RE 800R
Rave RE 600 E-TEC
Rave LC 600
Rave FC 550
Xtrim FC 550
Xtrim SC 600 E-TEC
Xtrim SC 800

XU Xtrim Commander 600 HO SDI

2009

Ranger 550 (RF)*
Ranger V800 (RF)*
Adventure V800 (RF)*
Adventure 550 LX (REVO)*

XU Adventure Grand Tourer 600 HO SDI

YETI Pro 800 (YETI)*
YETI Pro 550 (YETI)*
YETI SUV 800 (YETI)*
YETI SUV 550 (YETI)*

REX Rave RE 800R
Rave RE 600 E-TEC
Rave LC 600
Xtrim SC 600 E-TEC
Xtrim SC 800

Rave 550 (REVO)*
Xtrim 550 (REVO)*

XU Xtrim Commander LXU 600 HO SDI



XTRIM COMMANDER
• 800R E-TEC
• 600 E-TEC
• LIMITED 600 E-TEC

ADVENTURE GRAND TOURER
• 1200 4-TEC
• 600 E-TEC

49 RANGER
• 600 E-TEC
• 600 ACE

69 YETI
• ARMY 600 E-TEC
• 600 ACE

ADVENTURE LX 600 ACE

59 YETI
• 550
• 600 ACE

* For more information about accessories for RF, REVO and YETI sleds, ask your local dealer!

ACCESSORIES

FOR THE ULTIMATE RIDING EXPERIENCE.



IN EXTREME CONDITIONS you can trust not just your sled but also authentic Lynx accessories. They give you and your sled extra protection against the forces of nature and survive even the toughest of trips. Lynx accessories make your sled perfect just for you and your next adventure.

SKIS

BLADE

The ski is complete and includes e.g. a runner (605349378)



BLADE BLACK

860200884



BLADE WHITE

860200885



BLADE YELLOW

860201014



BLADE BLUE

860201015



BLADE GREEN

860201016



BLADE RED

860201017



C&A XT EXTREME BLACK (PAIR)

860200963



C&A XTX EXTREME CROSSOVER BLACK (PAIR)

C&A SKI MOUNTING KIT

860200960

C&A CARBIDE RUNNER 6"

860200969

C&A CARBIDE RUNNER 8"

860200968

C&A CARBIDE RUNNER 10"

860200967

Sold individually.



BLADE SKI HANDLE

505072976, Black
505073107, Yellow
505073108, White
505073388, Red
505073513, Orange



C&A SKI HANDLE, BLACK (SINGLE, SPARE PART)

860200961



LinQ is a sturdy attachment system for accessories. It makes accessories quick and easy to attach and detach and transforms your snowmobile to fit your needs in seconds.

QUICK: Plug in your accessories in seconds.

EASY: No tools required.

RELIABLE: Integrated locking mechanism.

UNIQUE: Specially designed for BRP products.

LinQ CARGO BOX, LARGE

860201082
Volume 40 L. Only available for 3,700 mm+ models.



LinQ CARGO RACK

860201059
Handy extra rack to combine with the cargo box.



LinQ 1+1 SEAT KIT WITH HANDLES

860201110

LinQ 1 + 1 SEAT, COMPLETE

860201058
BoonDockers require seat
No 860201073 (Xtrim seat range).



LinQ ANCHOR BASE KIT

860201111



LinQ BAG (SMALL) 10 + 3 L

860200918



LinQ BAG (MEDIUM) 19+3L

860200917



LinQ BACKPACK

860200921
Wear as a backpack or strap to LinQ locks (requires attachment kit No 860200583, sold separately).



LinQ JERRY CAN

860200733



LinQ CARGO RACK

860201003
Cargo rack for LinQ bags and jerry can.



LinQ ATTACHMENT KIT

860200945



QUICK ATTACHMENT KIT

860200583



HANDLEBAR BAG, LARGE AND SMALL



Large (175 mm →), volume 5 L
860200919

Small (all heights), volume 3 L
860200920



CARGO BOX FOR SNOWMOBILE CARGO SLED

860201066



JERRY CAN KIT FOR SNOWMOBILE CARGO SLED

860201067



LinQ PROTECTIVE DECALS

860200767



LinQ (SPARE PART)

715001707

Sold in pairs.

Swivel lock left 860201137

Swivel lock right 860201138



LinQ SYSTEM™

SNOWMOBILE CARGO SLED

860201065

Advanced cargo sled compatible with LinQ accessories. The sled in the picture is equipped with extra sides, 2 x 715001665.



WIND PROTECTION & MIRRORS



WINDSHIELD, HIGH
860201070
REX 



WINDSHIELD, MEDIUM
860201071
REX



WINDSHIELD, LOW
860200759
Supplied as standard with Rave sleds.
REX



WINDSHIELD, EXTRA LOW
860200901
REX



SNOW DEFLECTOR
860200603 + 860200937
REX 



WINDSHIELD, HIGH
860200547
REX



WINDSHIELD, EXTRA HIGH
860200225
REX



WINDSHIELD, HIGH
517304395
Requires side deflectors and attachment kit.
REX

WINDSHIELD, LOW
517304293
REX



WINDSHIELD, LOW
860200439
Supplied with side deflectors + attachment kit.
REX



WINDSHIELD, LOW
517305098
XU



WINDSHIELD, MEDIUM
860200453
XU



WINDSHIELD, EXTRA HIGH
700 mm
860200227
XU



WINDSHIELD, HIGH
860200438
Supplied with side deflectors + attachment kit.
XU



WINDSHIELD, EXTRA HIGH,
629 mm
860201000
XU

AIR DEFLECTOR EXTENSION KIT
860200435
REX
REX 



MIRROR KIT FOR AIR DEFLECTORS
860200674
REX **REX**



HANDLEBAR AIR DEFLECTORS
Red: 517305050
White: 517305053
REX **REX**

**HANDLEBAR AIR DEFLECTORS,
WHITE**

619400081



SIDE COVER AIR DEFLECTORS

860201068



MIRROR KIT, ROUND

619400057



SIDE COVER AIR DEFLECTORS

517304504



ERGONOMICS

HAND MUFFS

860201093



RAVE SEATS

860201072



SIDE DEFLECTORS, EXTRA LOW

860200498



XTRIM SEATS

860201073



AIR DEFLECTOR KIT (for windshield)

619560022



BOONDOCKER SEATS

860201055



**WINDSHIELD BASE KIT,
MEDIUM AND HIGH**

860200091

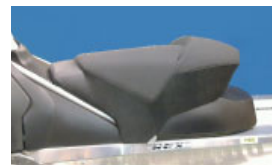

HIGH RISE SEAT KIT

20 mm

860200681



WINDSHIELD BASE KIT, LOW

860200089



WINDSHIELD BASE KIT

Extra high: 860200230

Medium and high: 860200229

Low: 860200228





HANDLEBAR RISER 115 mm
860200268



HANDLEBAR RISER 165 mm
860200526



ADJUSTABLE HANDLEBAR RISER, LOW

860201123
Adjustability: 130 - 205 mm



ADJUSTABLE HANDLEBAR RISER, FOR FATBAR

860201124
Adjustability: 185 - 250 mm



ADJUSTABLE HANDLEBAR RISER, FOR FATBAR

860201125
Adjustability: 115-175 mm



ADJUSTABLE HANDLEBAR RISER
619400056



RE SHOCK ABSORBER KIT FOR PLATFORM

860201052



RE SHOCK ABSORBER KIT FOR THE FRONT

860201051

Only available for 1,070-mm fronts.



FOX SHOCK ABSORBER KIT, SKIS AND FOX FLOAT GUARD

Only available for 900-mm fronts.

860200958

860201011



FRONT SUSPENSION NARROWING KIT, 910 mm

860200898

Supplied with shock absorbers. (Not suitable for the 59 and 69 YETI.)



FRONT SUSPENSION WIDENING KIT, 1,070 mm

860200800

Widening kit for 910-mm/975-mm fronts. (Not suitable for the 59 and 69 YETI.)



SWAY BAR QUICK DISCONNECT LINK KIT

860200667

(Not suitable for the 59 and 69 YETI.)



ECS KIT

860201139

Available for all XU models with a 46-mm rear arm shock absorber. ECS lets you adjust the rear arm spring preload directly from the handlebar according to load and conditions.



FRONT BUMPERS



FRONT BUMPER

860200932
Light aluminum.



HEAVY-DUTY BOOSTER BUMPER

860200542

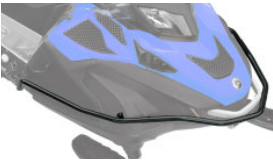

BOOSTER BUMPER

860200391
Only available for the 59 and 69 YETI.



BOOSTER BUMPER

860200537
Not suitable for the 59 and 69 YETI.



FRONT BUMPER

Red: 502007370
White: 502007275
Orange: 502007323



TOWING AND REAR BUMPERS



REAR BUMPER, REINFORCED FOR TOWING

860201091
Available for 3,300-mm and 3,700-mm chassis.

860201090
Available for 3,900-mm chassis.



REAR BUMPER, REINFORCED FOR TOWING 146"

860200953



TOW HITCH

860200886
Available for all REX²/Rex models with a reinforced bumper.



TOW HITCH

860200751
Available for Adventure LX models.



WINCH KIT

619400069



ELECTRICAL AND REWIND STARTERS



ELECTRIC STARTER KIT

619400084



REWIND STARTER KIT

+ 512060451
860201053
(Not suitable for the 59 and 69 YETI.)



COVERS

COVER, FOR STANDARD SEAT

280000660



COVER, FOR 1+1 SEAT

280000661



SLED COVER

280000509

Only available for the Adventure LX 600 2011.



COVER, FOR REX MODELS WITH 1+1 SEAT

619500010



WHITE ARMY COVER

21149



SLED COVER

619500009



SLED COVER

619500011

Also fits 49 Ranger- and Adventure LX 2012 600-model.



SHOVELS

SHOVEL/SAW

860200574

Saw handle for shovel.

860200794



SHOVEL MOUNTING KIT

860200322



TRANSMISSION

QRS RACING SUPPORT

860200783



FLOATING QRS SHORT SHAFT CONVERSION KIT

860200832



HELIX 40

417126956

HELIX 38

417126962

HELIX 44-42

417126973

HELIX 44-40

417126974

HELIX 44-33

417126975

HELIX 46-42

417126976

HELIX 44

417127011

HELIX 42

417127012



COOLING

FILTER KIT FOR HOOD

517305029



ICE SCRATCHERS

860201102



VENTILATION KIT

860200684

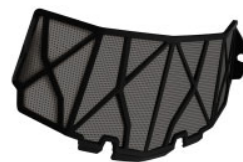

STORAGE



GLOVE COMPARTMENT EXTENSION

860200707



GPS BOX COVER

860200678



OIL/GOGGLE BAG

860201094



CARGO BOX

619560023



CARGO BOX RAILING

511000730

Available for box No 619560023.

CARGO BOX LOCK

511000729

Available for box No 619560023.



CARGO BOX

860200516

Available for the Adventure LX 2012 and the 49 Ranger.



CARGO BOX, CENTRAL

860200682

Volume 20 L.



CARGO RACK RISER KIT

619400064

Not suitable for the 69 YETI.



1+1 SEATS & ACCESSORIES



1+1 SEAT, COMPLETE

860201058

BoonDockers require seat No 860201073 (Xtrim seat range).



XTRIM SEATS

860201073



1+1 SEAT

619400047

Available for REX models with a Sport seat with cargo compartment.



1+1 SEAT

619590120

For Rex models with a Racing seat with no cargo compartment.



LUXUS EXTRA SEAT

619400068



LIGHTWEIGHT EXTRA SEAT

860200543



1+1 SEAT BACKREST

860200060

Available for seats No 619400047 and 619590120.



1+1 SEATS & ACCESSORIES

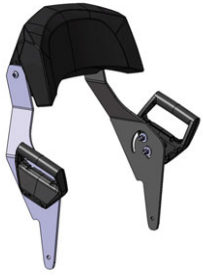

BACKREST KIT WITH LIGHTWEIGHT GRIPS

860200554
Fits 49 Ranger-model.

GRIP KIT (HEATED) FOR LIGHTWEIGHT SEAT

860200553



PASSENGER FOOTRESTS FOR 1+1 SEAT

860200295



HEATED PASSENGER GRIPS

619400065



ENGINE HEATER KIT

860200367
Available for the 600 ACE, the 900 ACE and the 1200 4-TEC.



CTEK BRP 5.0 CHARGER

860200997



ELECTRIC HORN

860200286



WORK LIGHT KIT

619400017



LEARNING KEY (PROGRAMMABLE)

860200907



DESS SPARE KEY

515177057

Ask your dealer to program the key for your sled.



3-W HEATER

515176786



HEATED VISOR KIT

860200628



POWER OUTLET FOR REAR RACK BOX

860200285



ELECTRICAL



GARMIN MONTANA 650T GPS KIT

860200631



GPS HOLDER

860200707

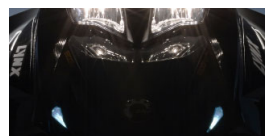

DAYTIME RUNNING LIGHT KIT

860201074



LED BOOSTER LIGHT KIT

860201050





POWER OUTLET FOR HEATED VISOR

619590073
619590074



POWER OUTLET

860200632
619590072



SKID PLATE

Black: 860200544
Only available for the 59 YETI.

SKID PLATE

Black: 860200691
Only available for the 69 YETI.



HD GEARBOX AND BRAKE DISK PROTECTOR KIT

860201134



HD GEARBOX AND BRAKE DISK PROTECTOR KIT

860200527



SKID PLATES & PROTECTORS



SKID PLATE

Black: 860201046
Orange: 860201049
White: 860201047
Gray: 860201048



HD GEARBOX AND BRAKE DISK PROTECTOR KIT

860200550

Only available for A-arm models.



SKID PLATE

Only available for A-arm models.
Black: 619400035
Red: 619400059
White: 860200411



FRAME UNDERBELLY

860200905
Standard in RS 600-models.



A-ARM PROTECTORS

619590071



SKID PLATE

Black: 860200540

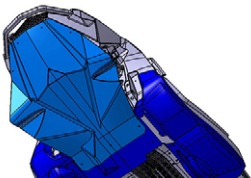

SKID PLATE

White: 860200552
Black: 860200549
Not suitable for the 59 and 69 YETI.





XPS SYNTHETIC CHAINCASE OIL, 355 ML

619590098
The best in multigrade chain lubrication, specifically developed for high-performance models. Offers wide operating range of temperatures.

XPS SYNTHETIC GEARBOX OIL, 1 L

619590182
(Not illustrated)
Models with gearbox



XPS STORAGE OIL, 350 g

619590094
Protects the engine's internal parts against corrosion and moisture out of season.



XPS MINERAL GEARBOX OIL, 250 ml

619590099
Mineral-based gearbox oil.



FUEL STABILIZER, 237 ml

619590096
Fuel additive for protection against fuel contamination and residue build-up in carburetors and gas lines. Highly recommended for use before snowmobile storage. Suitable for all gasoline engines.



XPS FUEL LUBE, 414 ml

619590093
Multipurpose lubricant spray. Removes moisture and prevents corrosion and wear. The bottle also works upside down.

PRE-MIXED ANTIFREEZE/COOLANT, 1 L

619590183
Pre-mixed, ready to top up your coolant level. Blended to perform best in our Rotax engines with anti-corrosive additive.



FULLY SYNTHETIC XPS TWO-STROKE OIL

619590106 • 946 ml
619590107 • 3,785 ml

Fully synthetic XPS two-stroke oil provides ultimate protection for your Rotax engine and especially the E-TEC® 800R engine. Offers excellent thermal protection and lower emissions compared to traditional oils.



SEMISYNTHETIC XPS TWO-STROKE OIL

619590103 • 946 ml
619590104 • 3,785 ml

Premium two-stroke synthetic blend for best possible thermal protection, low friction and wear, and guaranteed engine cleanliness. Recommended for the Rotax E-TEC 600 HO, SDI and PowerTEK™ engines.



XPS TWO-STROKE MINERAL OIL

619590100 • 946 ml
619590101 • 3,785 ml

Mineral-based injection oil. Designed for oil-injected Rotax carburetor engines. Offers optimal oil flow even in extremely cold conditions. Low-ash oil for premium lubrication, protection against corrosion, and engine cleanliness. Also suitable for use as a pre-mix.



FULLY SYNTHETIC XPS FOUR-STROKE OIL FOR WINTER USE

619590114 • 946 ml
619590115 • 3,785 ml

SAE OW-40. This fully synthetic four-stroke oil is designed specifically for winter use in BRP products equipped with Rotax four-stroke engines. Facilitates start-up, protects the engine against wear, and ensures performance even in the most challenging winter conditions. Protection against rust and corrosion during storage.

TRACKS

38 X 305 (44 MM) 2.86"
504152883

38 X 305 (38.1 MM) 2.86"
605613005

38 X 330 (44 MM) 2.86"
504153154

38 X 330 (39 MM) 2.86"
504153091

38 X 330 (44 MM) 2.86"
504153162

**38 X 330 (35 MM) 2.86",
STUDED**
504153142

**HIGH-PROFILE TRACK
KIT, FOR BOONDOCKER
WITH 59-MM TRACK**
860200637

**TUNNEL PROTEC-
TION KIT FOR TRACK
NO 504153037**
860200737

**50 X 396 GLX 5900 98-03
(23 MM)**
13055

**50 X 396 GLX 5900 LC
(32 MM) 01 -> 02**
13070

**38 X 396 FOREST FOX/
RANGER KING 31.8 MM**
13074

60 X 396 (31.8 MM)
13081

41 X 370 (39 MM) 2.86"
504152987

38 X 370 (44 MM) 2.86"
504153012

41 X 370 (59 MM) 2.86"
504153014

41 X 370 (38 MM) 2.86"
605613006

**41 X 3,923 (39 MM)
2.86"**
504152962

**406 X 348 (44 MM)
2.86"**
504152803

**500 X 392 (31.8 MM)
2.86"**
504152817

**500 X 392 (38 MM)
2.86"**
605613004

**500 X 392 (32 MM)
2.86", STUDED**
504153036

**500 X 392 (38 MM)
2.86", STUDED**
504153037

500 X 392 (44 MM)
504153133

**600 X 3,968 (32 MM),
STUDED**
504153218

UNIVERSAL



LOCKABLE FUEL CAP
619590085



**HEATED GPS BOX, LARGE
AND HEATED GPS BOX,
SMALL (WIDESCREEN)**
Large: 619560013
Small: 860200725



**REAR-VIEW MIRROR
KIT (SMALL)**
619400009



TUNNEL GRIP PLATES
860200164



SUPERCLAMP
860200950
860200993
860200995
860200994



RACING BRAKE PADS
619690016



LINQ GRIPS
715001421
Handy way to attach long
items to your sled.



**PULLEY KIT FOR XU
WINCH**
715000279



MULTITOOL
520900002



SAW/SHOVEL
860200574

Lightweight shovel/saw. (Requires installation kit No 860200322, sold separately.)



AVALANCHE ROD
520000408

Lightweight and strong 12-mm aluminum rod for locating avalanche victims. Markers every 400 mm. Foldable. Weight 370 g.



BRP STOOL
415129015



BRP SLED TROLLEY
861002600

For indoor use. Easier maneuvering of sleds indoors.



BRP STRAPS

295100185 Quick Lock
295100183 Ratchet Lock
Heavy-duty cargo straps. Adjustable length between 0.3 m and 1.5 m, hooks at both ends.



EXTRA ATTACHMENT KIT FOR CARGO BOX

860200058
For attaching an extra strap to a quick-release lock (pack of 2).



HID LIGHTS

Xenon Lights
715001382

Incomparable and powerful HID long range illumination plug-and-play system converts night usage into virtually daytime riding. Integrated ballast unit with 81 mm clear glass lens and swivel mounting heavy-duty bracket provides compact design. Water and dust proof IP67 and IP6K9K. Highest electromagnetic compatibility rating, i.e. EMC Class 5 according to CISPR 25, for total disturbance-free electronic operation. Peak light performance with just 35W. Luminous flux is 2.5 times higher than conventional halogen bulb with 35% less energy consumption. High vibration resistance with longer lifetime than halogen bulb. Constant light intensity even under unsteady power supply voltage. Includes basic wiring and switch. Works in conjunction with halogen and/or HID lights separately or in combination without overloading your charging system. Sold in pack of 2.



HALOGEN LIGHTS

715001383

Delivers long range illumination. 81 mm clear glass lens and swivel mounting heavy-duty bracket provides compact design. Includes basic wiring and switch. Works in conjunction with halogen and/or HID lights separately or in combination without overloading your charging system. Sold in pack of 2.



RAM WORK LIGHT

715000007
High-intensity (37.5 watts), heavy-duty spotlight standard-equipped with 25 mm [1"] diameter rubber-coated double ball and socket system.



15-L JERRY CAN
715001424



5.5-L JERRY CAN
715001425



BRACKET FOR JERRY CAN
715001427



GUN CASE
715001419



BRACKET FOR GUN CASE
715001420



BRACKET FOR CHAINSAW
715001423

2014

Rave RS 600	417300425
Rave RE 800R E-TEC	417300391
Rave RE 600 E-TEC	417300383
Rave 600 ACE	417300127
Rave 550	414860700
Xtrim 600 ACE	417300127
Xtrim SC 600 E-TEC	417300383
Xtrim SC 900 ACE	417300383
BoonDocker RE 3700 800R	417300391
BoonDocker DS 3900 800R	417300391
BoonDocker 3700 600 E-TEC	417300383
BoonDocker 3900 600 E-TEC	417300383
Xtrim Commander 600 E-TEC	417300383
Xtrim Commander 800R E-TEC	417300391
Adventure Grand Tourer 600 E-TEC	417300383
Adventure Grand Tourer 1200 4-TEC	417300383
Adventure Grand Tourer 1200 4-TEC CE	417300391
Adventure LX 600 ACE	417300127
49 Ranger 600 E-TEC	417300383
49 Ranger 600 ACE	417300127
59 YETI 550	414860700
59 / 69 YETI 600 ACE	417300127
69 Ranger Alpine 1200	417300383
69 YETI Army 600 E-TEC	417300383

2013

Rave RS 600	417300425
Rave RE 800R E-TEC	417300391
Rave RE 600 E-teC	417300383
Rave GLS 3300	417300391
Rave 600 ACE	417300127
Rave / Xtrim 550	414860700
Xtrim 600 ACE	417300127
Xtrim SC 600 E-TEC	417300383
BoonDocker 3700 800R	417300391
BoonDocker 3900 800R	417300391
BoonDocker 3700 600 E-TEC	417300383
Xtrim Commander 600 E-TEC	417300383
Adventure Grand Tourer 600 E-TEC	417300383
Adventure Grand Tourer 1200 4-TEC	417300383
Adventure Grand Tourer 1200 4-TEC CE	417300391
Adventure LX 600 ACE	417300127
49 Ranger 600 E-TEC	417300383
49 Ranger 600 ACE	417300127
59 YETI 550	414860700
59 / 69 YETI 600 ACE	417300127
69 Ranger Alpine 1200	417300383
69 YETI Army 600 E-TEC	417300383
69 Ranger Alpine 1200	417300383
69 YETI Army 600 E-TEC	417300383

2012

Rave RS 600	417300425
Rave RE 800R E-TEC	417300391
Rave RE 600 E-teC	417300383
Rave GLS 3300	417300383
Rave 600 ACE	414860700/
	417300127
Rave 550 / Xtrim 550	414860700
Xtrim 600 ACE	414860700/
	417300127
Xtrim SC 600 E-TEC	417300383
Xtrim BoonDocker 800R E-TEC	417300391
Xtrim Commander 600 E-TEC	417300383

Adventure Grand Tourer 600 E-TEC / 1200 4-TEC	417300383
Adventure LX 600 ACE	414860700
49 Ranger 600 E-TEC	417300383
49 Ranger 600 ACE	417300127
59 YETI 550	414860700
59 YETI 600 ACE /	414860700/
69 YETI 600 ACE	417300127
49 Ranger 600 E-TEC	417300383
49 Ranger 600 ACE	417300127
59 YETI 550	414860700
59 / 69 YETI 600 ACE	417300127

2011

Rave RS 600	417300288
Rave RE 800R E-TEC	417300391
Rave RE 600 E-TEC	417300383
Rave SC 600 E-TEC	417300383
Rave 550 / Xtrim 550	417300367
Xtrim SC 600 E-TEC	417300383
Xtrim BoonDocker 800R E-TEC	417300391
Xtrim Commander 600 E-TEC	417300383
Adventure Grand Tourer 600 E-TEC / 1200 4-TEC	417300383
Adventure LX 600 ACE	414860700
49 Ranger 600 E-TEC	417300383
59 YETI 600 ACE	414860700
YETI 550 / Pro v-800	605348425

2010

Rave RS 600	417300288
Rave RE 800	417300383
Rave RE 600 E-TEC	417300383
Rave LC 600	417300197
Rave 550	417300367
Xtrim 550	417300367
Xtrim SC 600 E-TEC	417300383
Xtrim SC 800	417300383
Xtrim Commander 600 SDI	417300383
Adventure Grand Tourer 600 SDI	417300383
YETI Pro 800 / 550	605348425
YETI Suv 800 / 550	605348425

2009

Rave RS 600	417300288
Rave RE 800	417300383
Rave RE 600 E-TEC	417300383
Rave LC 600	417300197
Rave 550	417300367
Xtrim 550	417300367
Xtrim SC 600 E-TEC	417300383
Xtrim SC 800	417300383
Xtrim Commander 600 SDI	417300383
Adventure Grand Tourer 600 SDI	417300383
YETI Pro 800 / 550	605348425
YETI Suv 800 / 550	605348425

THE WORLD IS OUR PLAYGROUND

Nothing is more valuable than your playtime. That is why BRP is dedicated to continually finding new and better ways to help you enjoy your favorite power sports. From snow to water to both on- and off-road fun, our passion for adventure fuels the innovations that result in the ultimate power sports experience for our customers. We value



the land and water we play on and are committed to protecting it. Our desire to thrill is paired with an emphasis on rider responsibility, placing personal safety above all else. So that each outing can be the most enjoyable, memorable and thrilling experience possible. Because your free time should always be your best time.

www.brp.com



SKI-DOO® LYNX® SEA-DOO® EVINRUDE® JOHNSON® ROTAX® CAN-AM®



© 2013 BRP Finland Oy. All rights reserved. ®, ™ and the BRP logo are trademarks of Bombardier Recreational Products Inc. or its affiliates.
 *All other trademarks are the property of their respective owners. Printed in Finland. 619950348 Lynx PAC Catalogue 2014 EN.

Because of our ongoing commitment to product quality and innovation, we reserve the right at any time to discontinue or change specifications, prices, designs, features, models or equipment without incurring obligation. Always consult your snowmobile dealer when selecting a snowmobile for your particular needs and carefully read and pay special attention to your Operator's Guide, safety instructions and to the safety labeling on your snowmobile. Always ride responsibly and safely. Always wear appropriate clothing, including a helmet. Always observe applicable local laws and regulations. Don't drink and drive.

Units in pictures can be equipped with optional accessories.

